



Planning Committee B

22/00794/FUL

Northminster Business Park, Harwood Road

Upper Poppleton

Site Plan

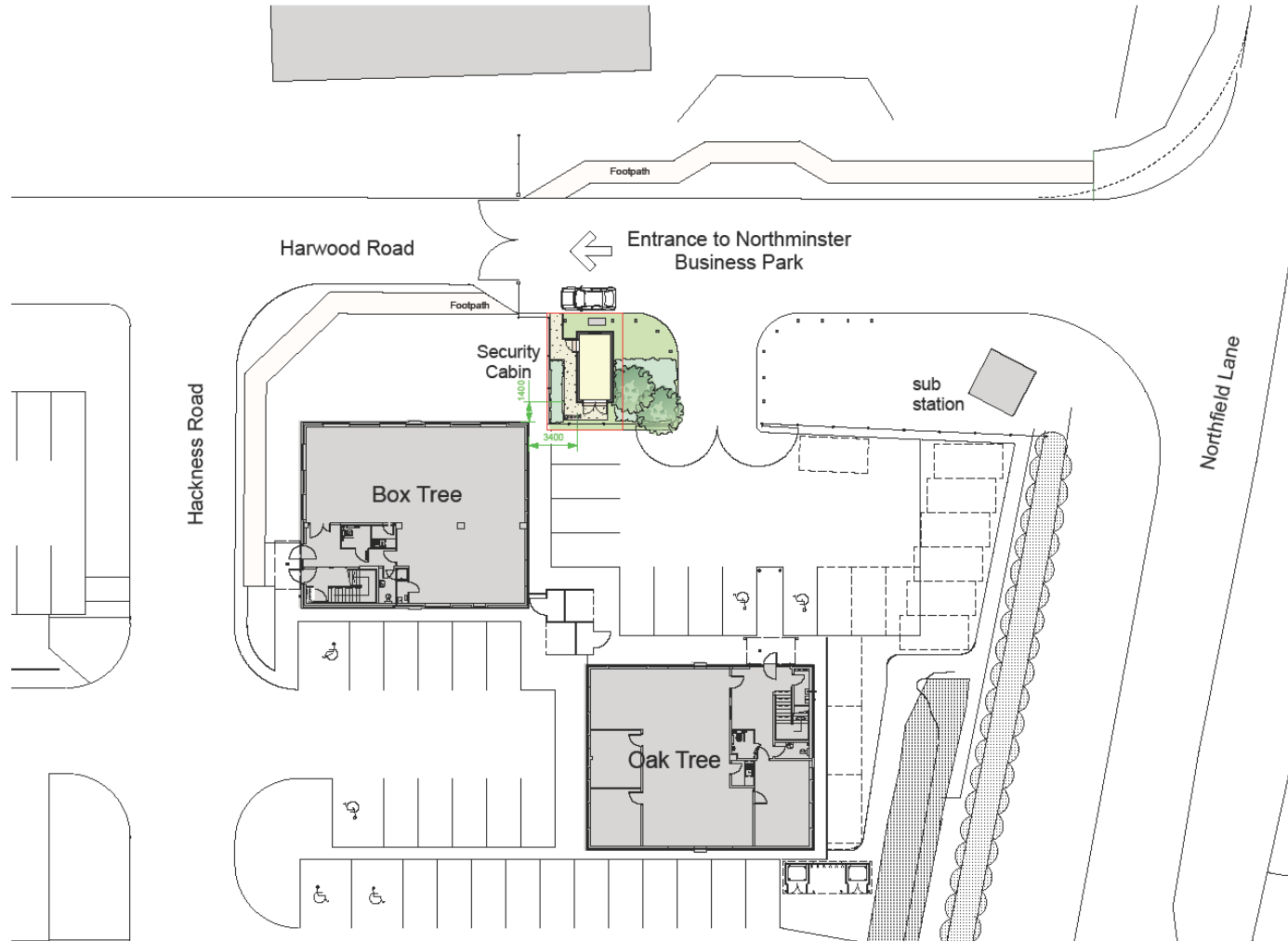

THIS DRAWING IS COPYRIGHT AND REMAINS THE PROPERTY OF HTC ARCHITECTS. IT MUST NOT BE REPRODUCED, USED, DISCLOSED OR TRANSMITTED TO THIRD PARTIES IN ANY FORM, IN WHOLE OR IN PART, WITHOUT PRIOR WRITTEN PERMISSION.
DO NOT SCALE!
ALL DIMENSIONS SHOULD BE CHECKED ON SITE BEFORE WORK COMMENCES
SEE ENGINEERS DETAILS FOR ALL STRUCTURAL INFORMATION

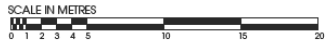

Rev	Date	Description	Drawn
D	08.08.22	Footpath included	tp
C	11.04.22	Boundary added	PJD
B	28.03.22	Existing tree position altered, gravel added	PJD
A	23.03.22	Existing landscape altered	PJD

htcarchitects
York Place Studio
8 Britannia Street
Leeds, LS1 2DZ
T: 0113 244 3457
E: info@htcarchitects.co.uk
www.htcarchitects.co.uk

Client
Northminster Limited.

Project
**Proposed Security Cabin,
Northminster Business Park, York.**

Drawing title
Proposed Site Layout

Drawn By **TJC** Checked By **PJD**
Scale **1:200 @ A2** Date **21.03.2022**
Drawing no. **2852.P401** Revision **D**

THIS DRAWING IS COPYRIGHT AND REMAINS THE PROPERTY OF HTC ARCHITECTS. IT MUST NOT BE REPRODUCED, LOANED, DISCLOSED OR TRANSMITTED TO THIRD PARTIES IN ANY FORM, IN WHOLE OR IN PART, WITHOUT PRIOR WRITTEN PERMISSION.
 DO NOT SCALE!
 ALL DIMENSIONS SHOULD BE CHECKED ON SITE BEFORE WORK COMMENCES
 SEE ENGINEERS DETAILS FOR ALL STRUCTURAL INFORMATION

Wider site plan

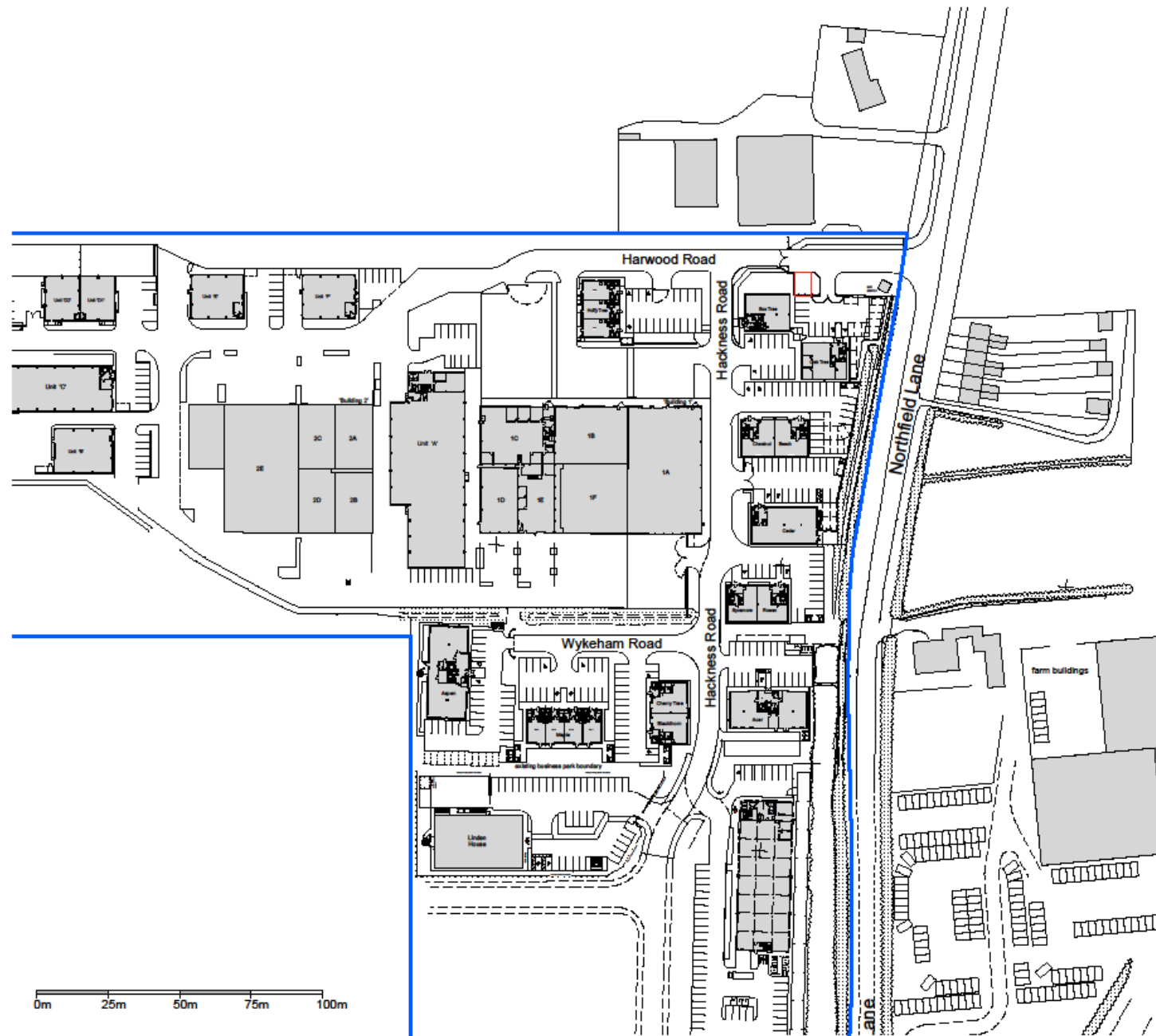

Revisions

htcarchitects

York Place Studio T: 0113 244 3457
 8 Britannia Street E: info@htcarchitects.co.uk
 Leeds, LS1 2DZ www.htcarchitects.co.uk

Client **Northminster Limited.**

Project
Proposed Security Cabin
 Northminster Business Park, York.

Drawing title
Wider Site Location

Drawn by **tjc** Checked by **pjb**
 Scale **1:1250 @ A3** Date **05.05.2022**
 Drawing no. **2552-P403** Revision **-**

Elevations and floor plan



THIS DRAWING IS COPYRIGHT AND REMAINS THE PROPERTY OF HTC ARCHITECTS. IT MUST NOT BE REPRODUCED, USED, DISCLOSED OR TRANSMITTED TO THIRD PARTIES IN ANY FORM, IN WHOLE OR IN PART, WITHOUT PRIOR WRITTEN PERMISSION.

DO NOT SCALE!
ALL DIMENSIONS SHOULD BE CHECKED ON SITE BEFORE WORK COMMENCES

SEE ENGINEERS DETAILS FOR ALL STRUCTURAL INFORMATION

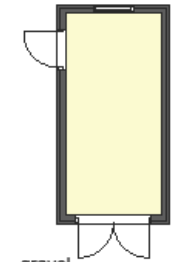

FLOOR PLAN

Rev.	Date	Description	Drawn
C.	23.03.22	Window to North elevation put back.	PJD
B.	23.03.22	Existing landscape altered.	PJD
A.	23.03.22	Fencing and existing landscape added.	PJD

htcarchitects

York Place Studio
8 Britannia Street
Leeds, LS1 2DZ

T: 0113 244 3457
E: info@htcarchitects.co.uk
www.htcarchitects.co.uk

Client
Northminster Limited.

Project
**Proposed Security Cabin,
Northminster Business Park, York.**

Drawing title
Proposed Floor Plan and Elevations

Drawn By	TJC	Checked By	PJD
Scale	1:100 @ A3	Date	21.03.2022
Drawing no.	2852.P100	Revision	C

Business Park
Entrance



Northfield Lane and
Site entrance

